

GROUND FLOOR, MILLENNIUM GRANDSTAND

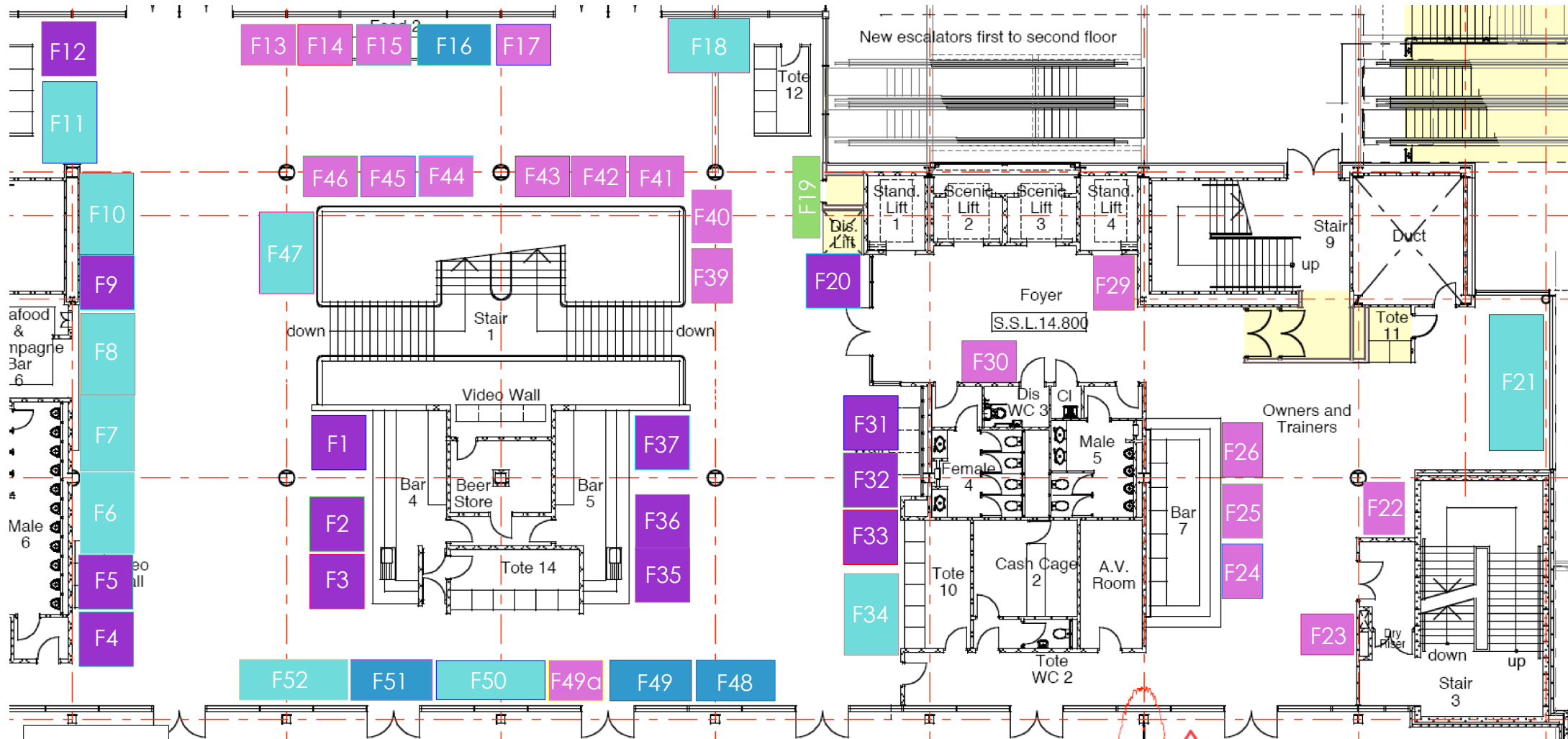

- Small Stands - 2m x 1.5m
- Medium Stands - 2m x 2m
- Medium Plus Stands - 3m
- Large Stands - 3m x 2m
- Small Long Stands - 3m x

FIRST FLOOR, MILLENNIUM GRANDSTAND

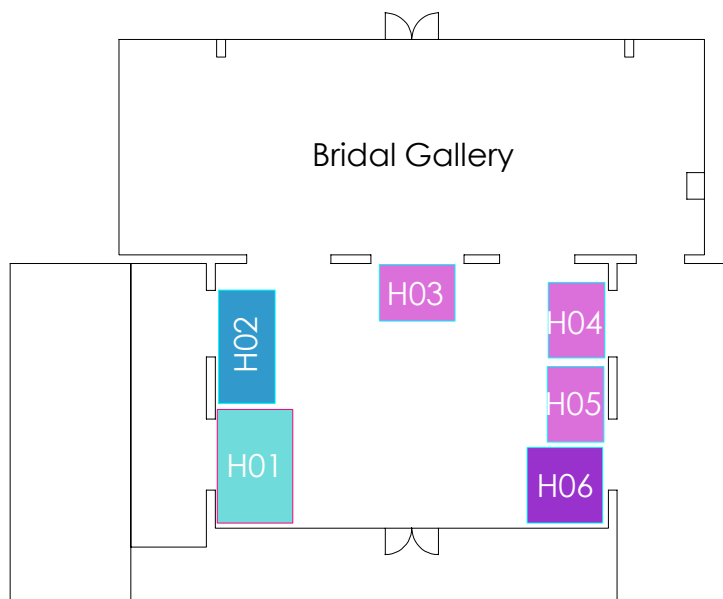

HONG KONG SUITE